



INSTRUCTION BULLETIN

No. 3610
Machine: 800/810
Published: 03-2005
Rev. 01

NOTE: DO NOT DISCARD Parts List from Instruction Bulletin. Place Parts List in the appropriate place in the machine manual for future reference. Retaining the Parts List will make it easier to reorder individual parts and will save the cost of ordering an entire kit.

NOTE: Numbers in parenthesis () are reference numbers for parts listed in Bill of Materials.

Installation Instructions for Retainer Replacement Kit 79117.

SYNOPSIS:

This kit contains the parts needed to replace the cable keeper bracket 800/810 machines. Please follow step-by-step instructions.

SPECIAL TOOLS / CONSIDERATIONS: NONE

(Estimated time to complete: 1 hour)

INSTALLATION:

(Refer to Figures 1 and 2)

FOR SAFETY: Before leaving or servicing machine, stop on level surface, set parking brake (if equipped on machine), turn off machine, and remove key.

1. Raise the hopper and engage the hopper support bar.



WARNING: Raised hopper may fall. Engage hopper support bar.

2. Remove existing cable keeper bracket from front right side of machine frame.
3. Assemble roller plate (1), existing cable pulley and sleeve on tower plate with existing hex screw and flat washer.
4. Thread lift cable over pulley and then install hex screw (3), flat washer (4) and spacer (2) in top hole of roller plate (1) over cable. Secure hex screw and spacer in place with hex flange nut (5).

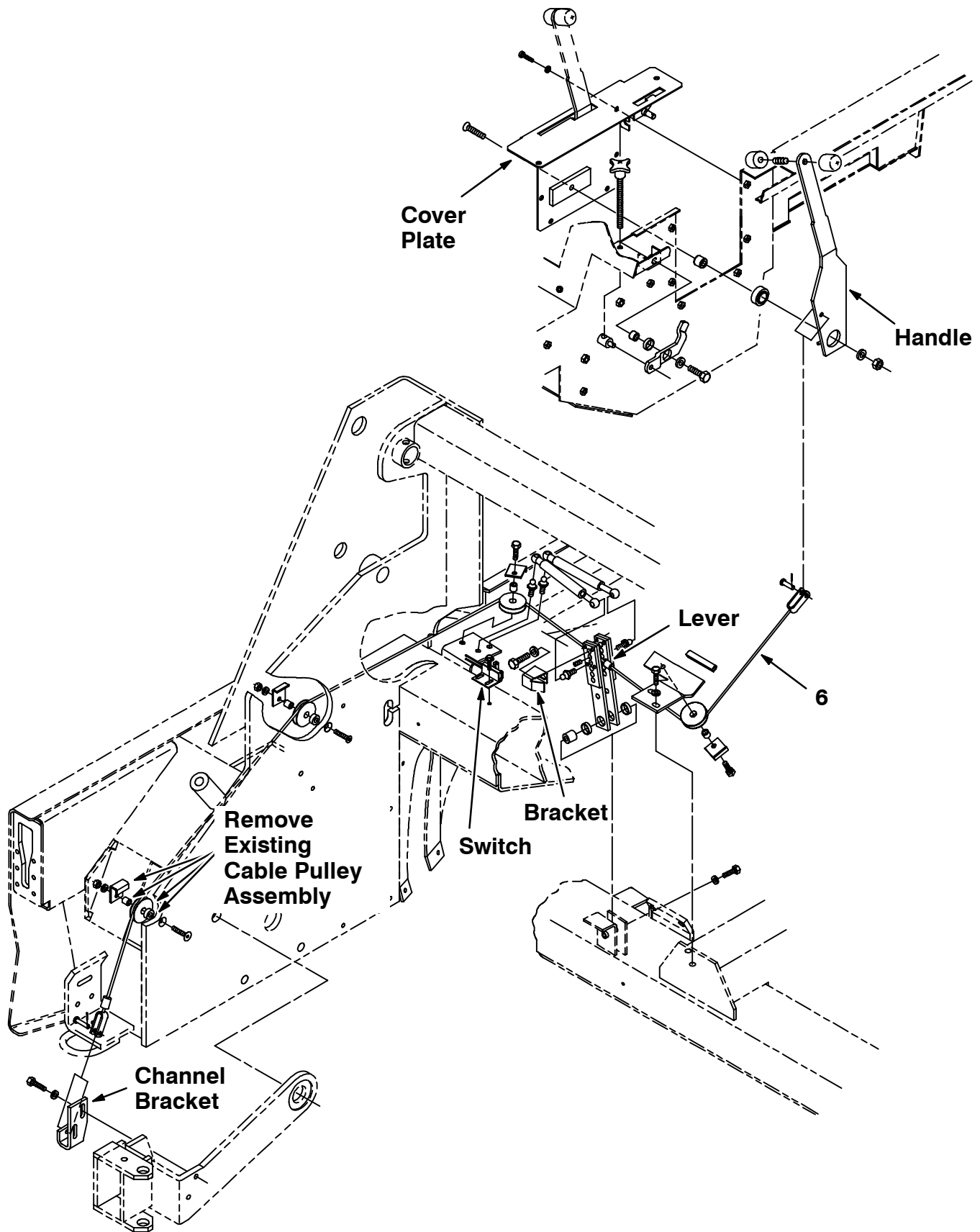

FIG. 1 – Existing Cable Keeper Bracket Assembly

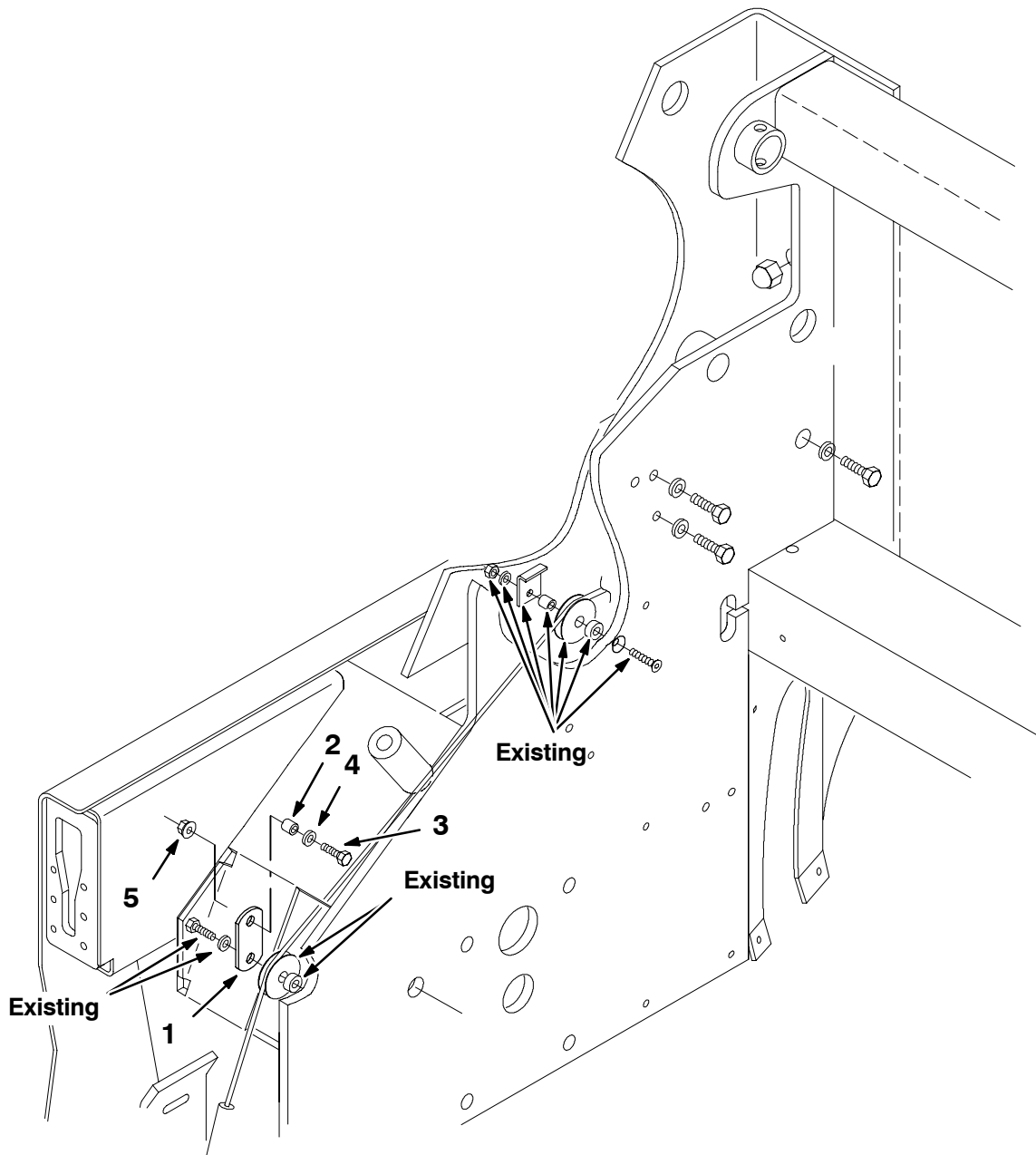

FIG. 2 – New Side Brush Lift Cable and Pulley Assembly

07615

Bill of Materials for Kit, Replmt, Retainer, Side Brush, [800L] – 79117

Ref.	TENNANT Part No.	Description	Qty.
1	375415	Plate, Side Brush, Roller	1
2	80395	Sleeve, P/M, 0.496D 0.318B 0.65L 430SS	1
3	76570	Screw, Hex, M8 X 1.25 X 30, 8.8	1
4	32492	Washer, Flat, 0.38 Std	1
5	07791	Nut, Hex Flange, M8 X 1.25	1

TENNANT COMPANY
P. O. Box 1452
Minneapolis, MN 55440-1452